

銅鑼灣

Causeway Bay

Revised Figures

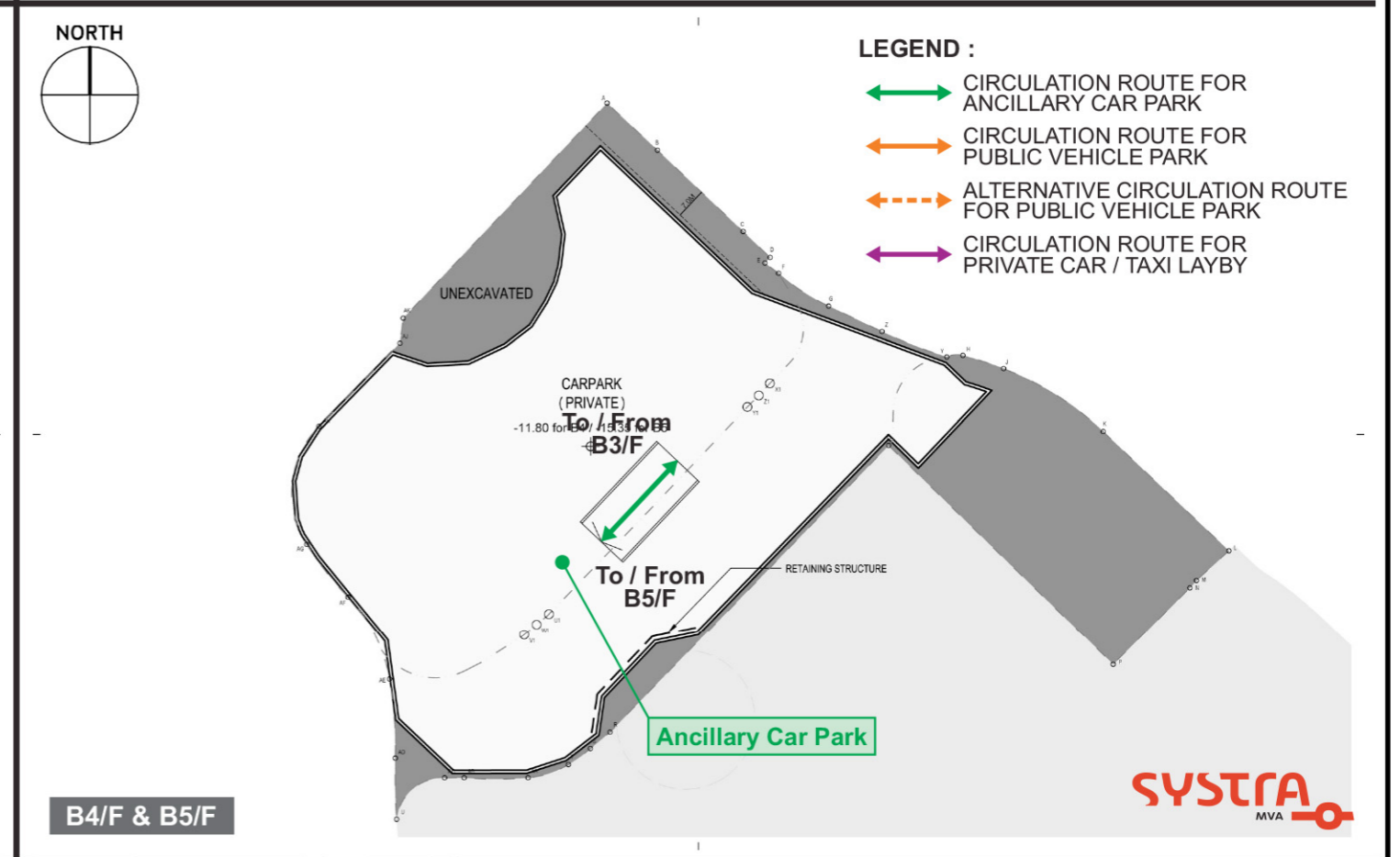

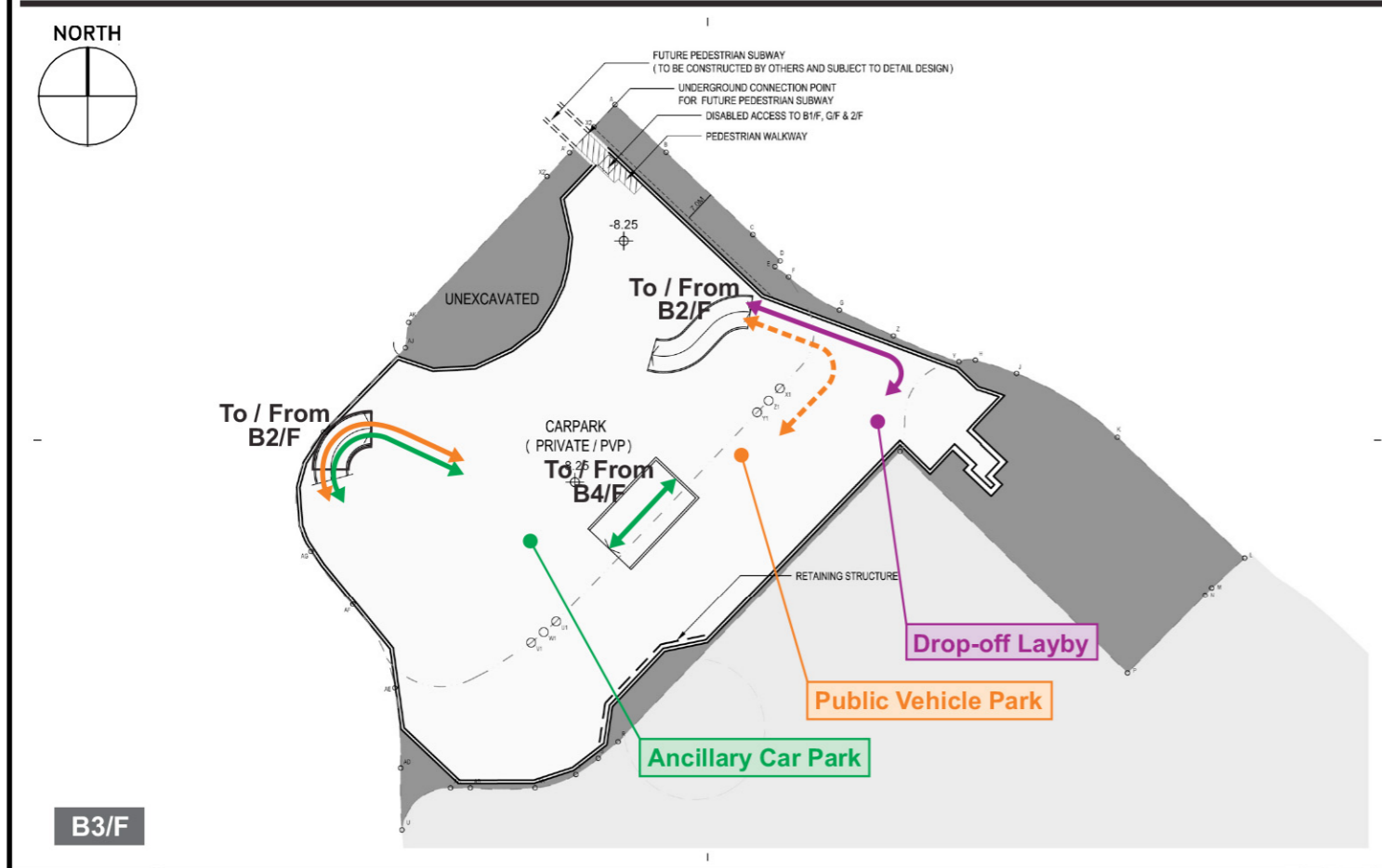
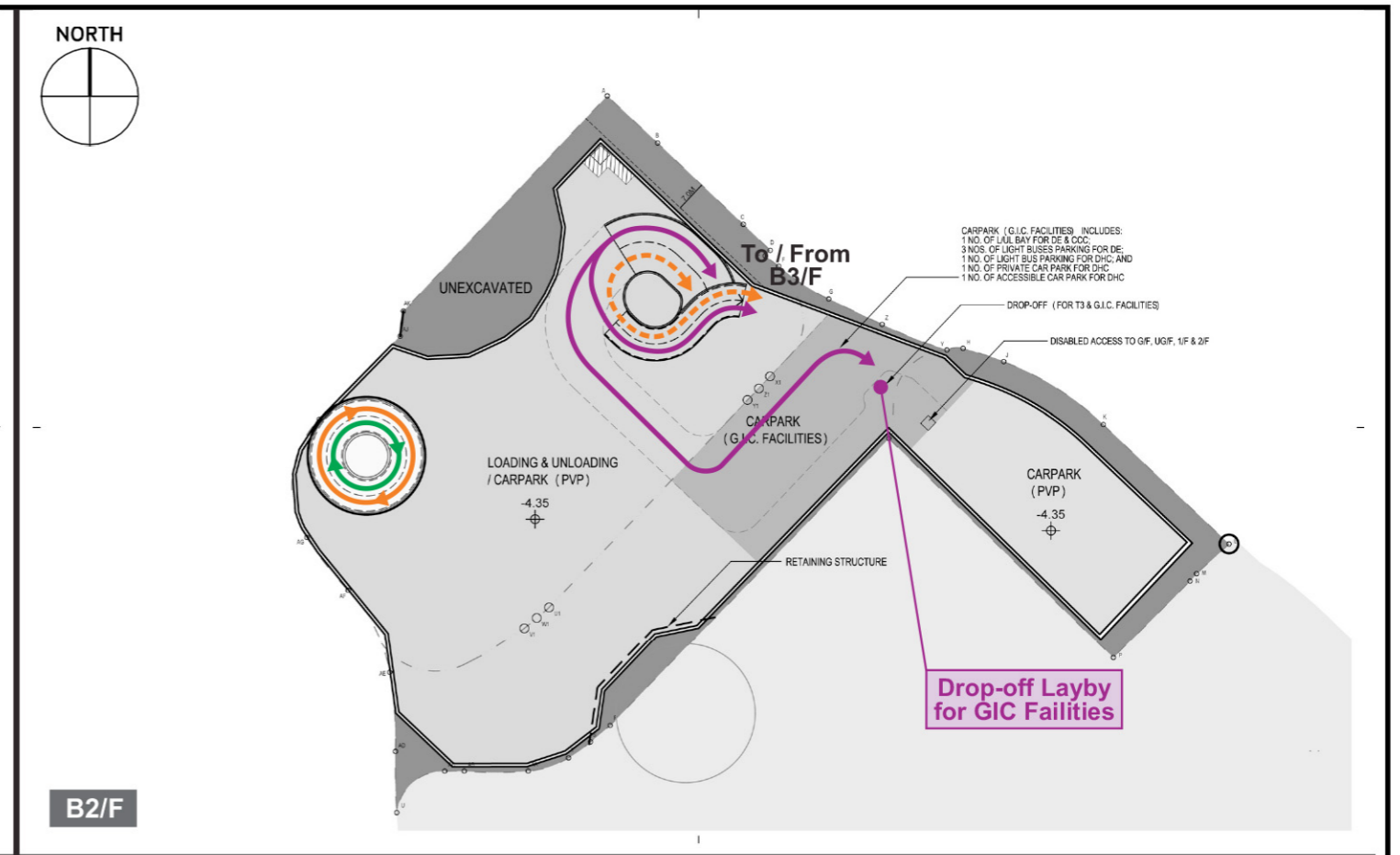
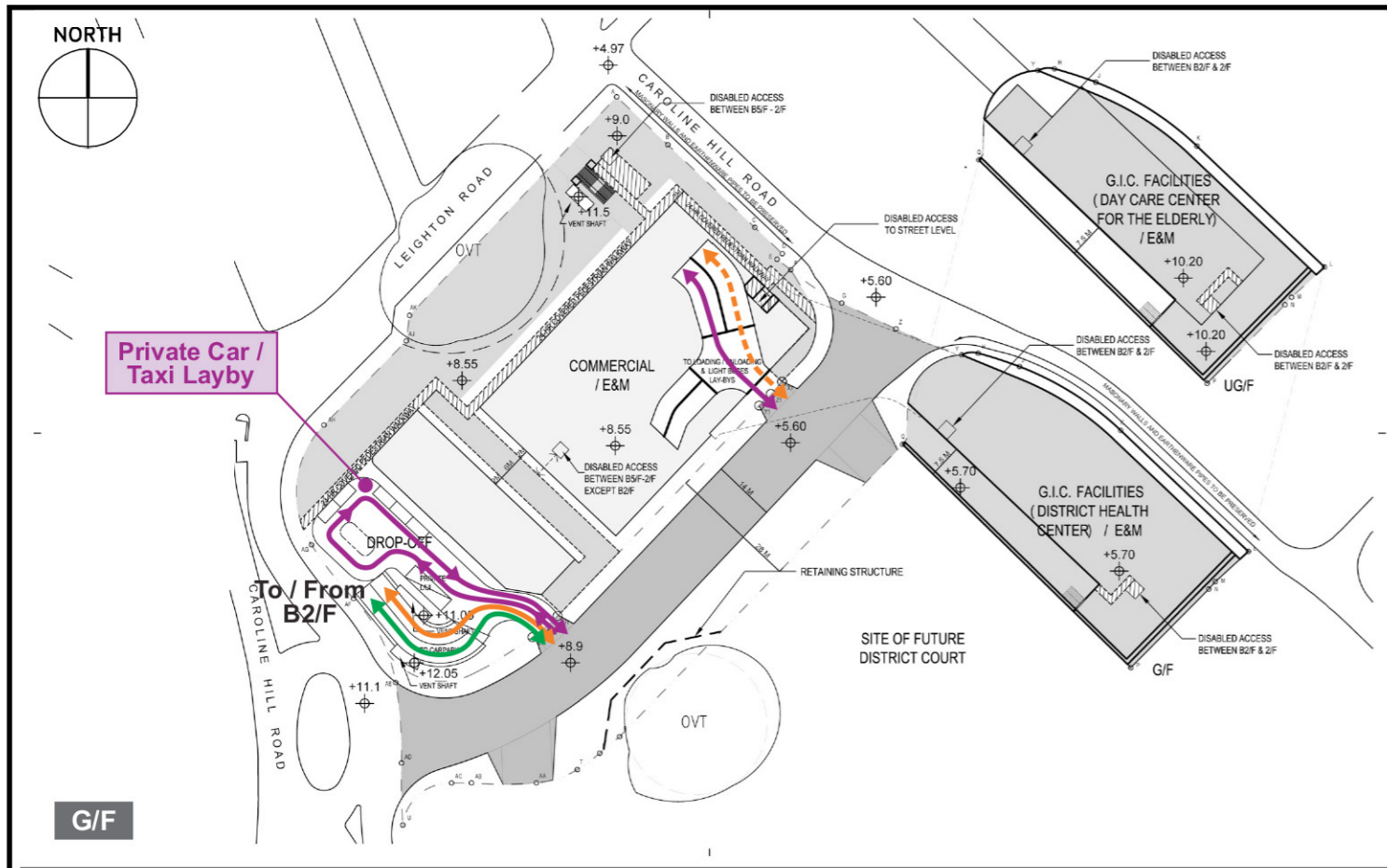

- LEGEND :**
- ↔ CIRCULATION ROUTE FOR ANCILLARY CAR PARK
 - ↔ CIRCULATION ROUTE FOR PUBLIC VEHICLE PARK
 - ↔ ALTERNATIVE CIRCULATION ROUTE FOR PUBLIC VEHICLE PARK
 - ↔ CIRCULATION ROUTE FOR PRIVATE CAR / TAXI LAYBY



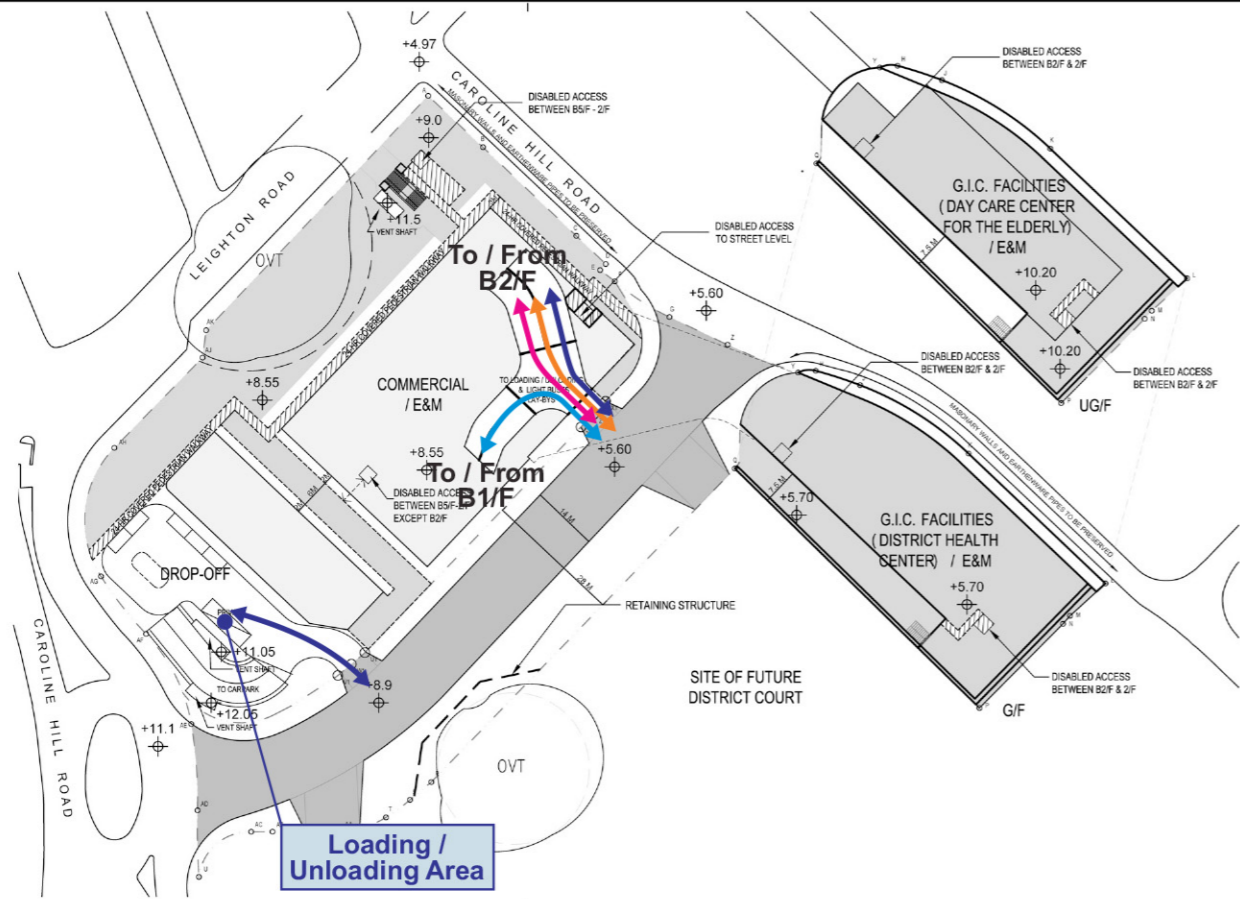

G/F

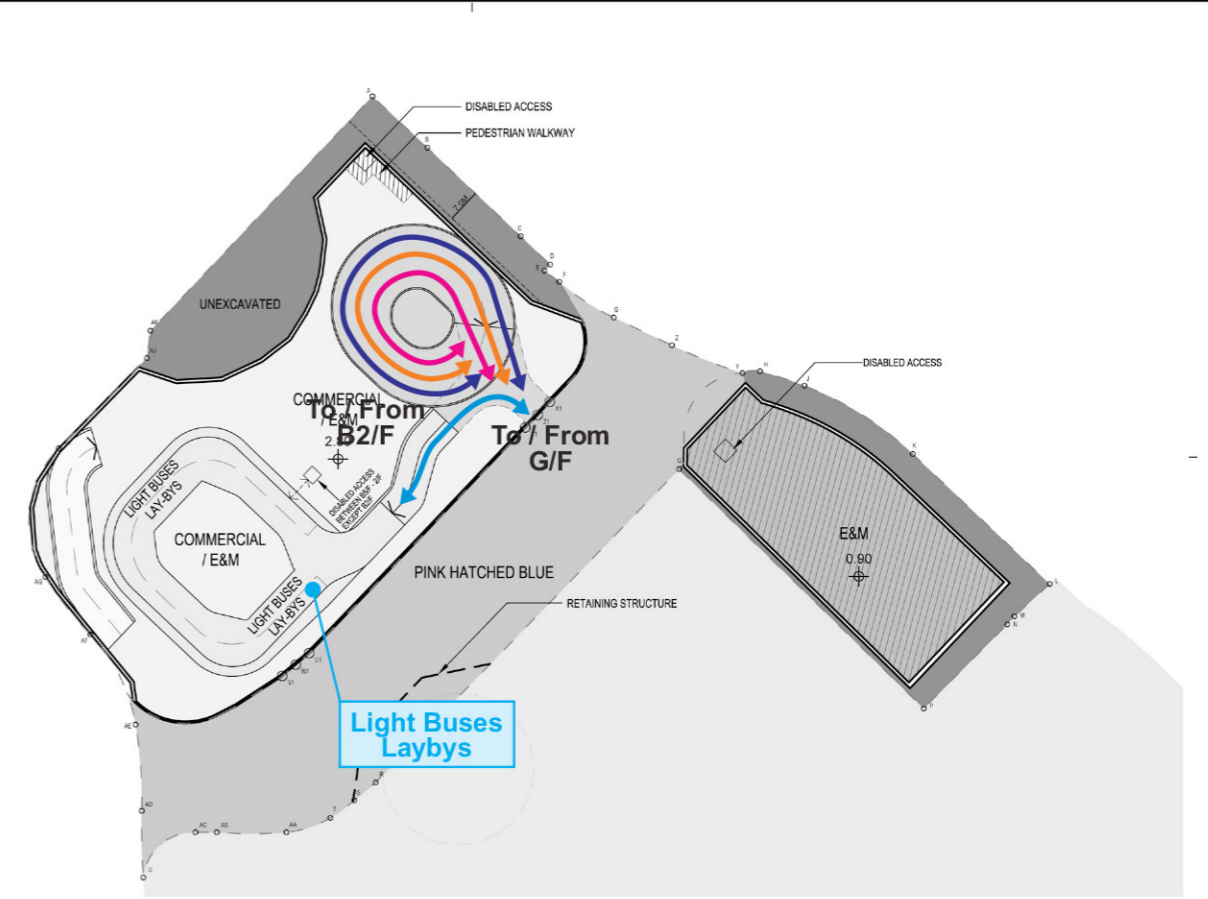

B1/F

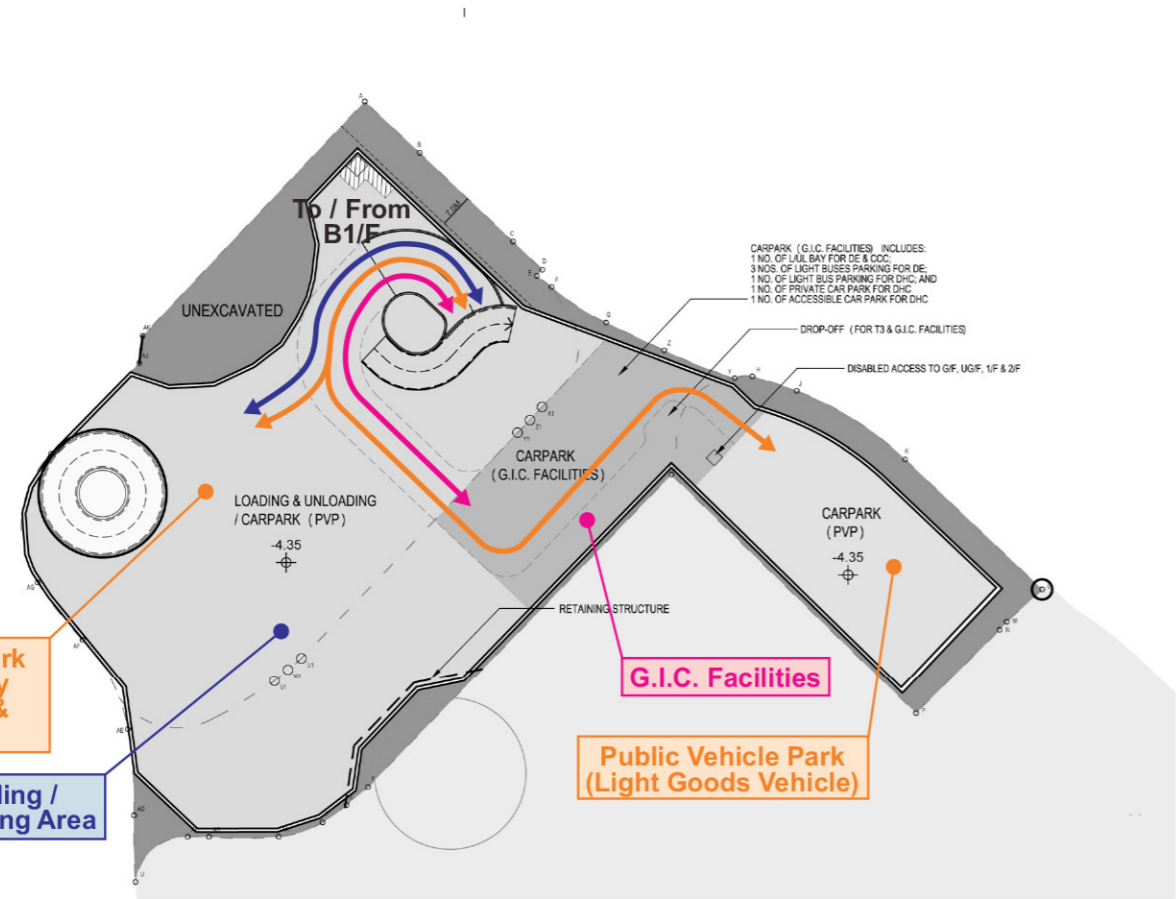

B2/F

LEGEND :

- CIRCULATION ROUTE FOR LIGHT BUSES LAYBYS
- CIRCULATION ROUTE FOR PUBLIC VEHICLE PARK
- CIRCULATION ROUTE FOR ANCILLARY LOADING / UNLOADING AREA
- CIRCULATION ROUTE FOR CAR PARK AND LOADING / UNLOADING OF G.I.C. FACILITIES



Patchway Holdings (HK) Limited



Submission of Layout Plan and Application for Commercial Development on IL No. 8945 Causeway Bay, Hong Kong



Title	Internal Traffic Arrangement and Circulation – Light Buses, Goods Vehicles and Coaches		
Scale	N.T.S.	Date	April 2024
Figure No.	4.13		

